

PRESENTATION – PRÉSENTATION – ANSICHT

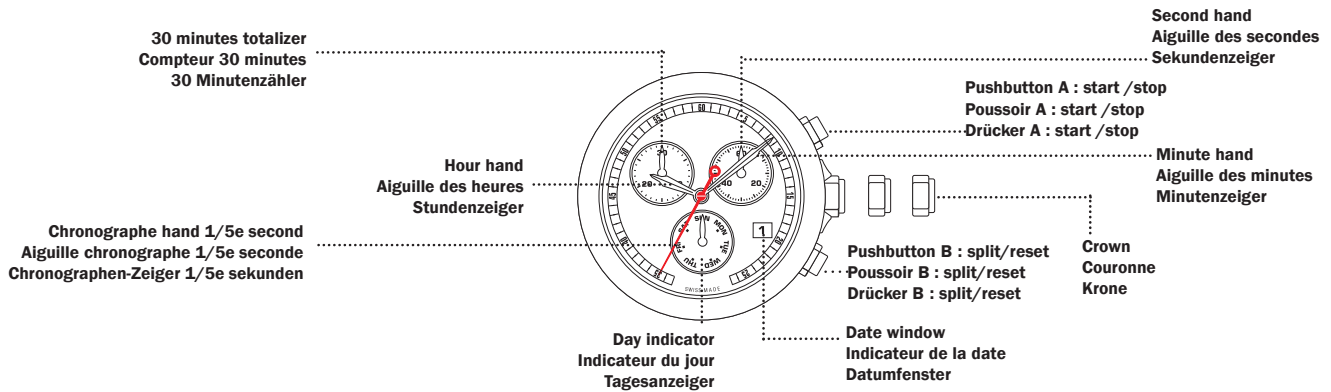

SETTINGS – REGLAGES – EINSTELLUNG

**SETTING THE TIME
HOUR AND MINUTE**

**REGLAGE DE L'HEURE
ET MINUTE**

**EINSTELLEN DER ZEITANZEIGE
STUNDEN UND MINUTEN**

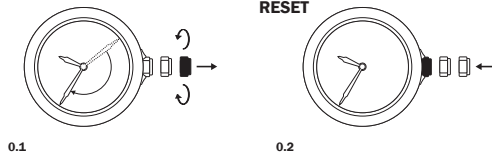

TO CORRECT THE DAY

CORRECTION DU JOUR

EINSTELLEN DES TAGES

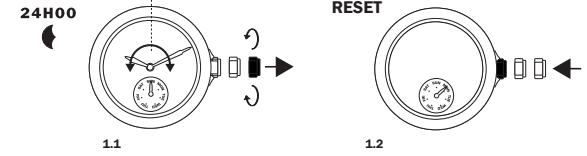

SETTING THE DATE
CAUTION: NEVER CORRECT DATE
BETWEEN 9 PM AND 0.30 AM.

CORRECTION DE LA DATE
ATTENTION: LA CORRECTION
DE LA DATE NE PEUT PAS
SE FAIRE ENTRE 21H00 ET 0H30.

EINSTELLEN DES DATUMS
ACHTUNG: DATUM NICHT
ZWISCHEN 21 UHR UND 0 UHR
30 EINSTELLEN.

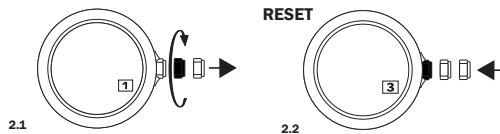

FUNCTIONS – FONCTIONS – FUNKTIONEN

MEASURING CUMULATIVE TIMES

MESURE DE TEMPS CUMULÉS

MESSUNG DER KUMULIERTEN ZEIT

AFTER 2 HOURS OF CONTINUOUS RUNNING, THE CHRONO STOPS AND RESETS AUTOMATICALLY TO SAVE THE BATTERY

APRÈS 2 HEURES DE MARCHÉ, LE CHRONO S'ARRÊTE ET SE REMET À ZÉRO AUTOMATIQUÉMENT AFIN D'ÉCONOMISER LA PILE.

NACH 2 LAUFSTUNDEN STOPPT DER CHRONO UND GEHT AUTOMATISCH AUF DIE NULLSTELLUNG ZURÜCK, UM DIE BATTERIESTROM ZU SPAREN.

START



STOP



RESET

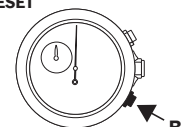

MEASURING SPLIT TIMES

MESURE DE TEMPS INTERMEDIAIRES

MESSUNG VON ZWISCHENZEITEN

START

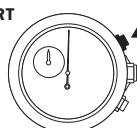

SPLIT

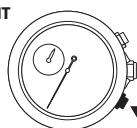

RESTART

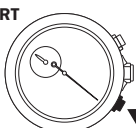

STOP

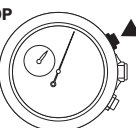

RESET

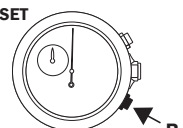

CALIBRATION – INITIALISATION
EICHEN

**AFTER BATTERY EXCHANGE
OR MISHANDLING ONLY**

TO RESET CHRONOGRAPH,
MINUTE AND SECOND CHRONOGRAPH

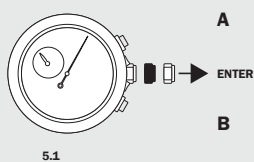

**SEULEMENT APRÈS CHANGEMENT DE
LA PILE OU MAUVAISE MANIPULATION**

INITIALISATION CHRONOGAPHE,
MINUTE ET SECONDE CHRONOGAPHE

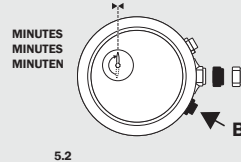

**NUR NACH BATTERIEWECHSEL
ODER UNKORREKTER HANDHABUNG**

INITIALISIEREN DES CHRONOGAPHE,
MINUTEN UND SEKUNDEN, CHRONOGAPHE

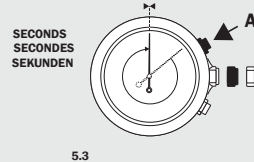

RESET

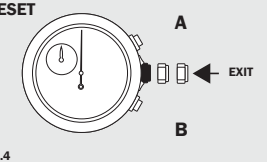

INFO

BATTERY - PILE - BATTERIE
395 - SR 57

SERVICE LIFE BATTERY: WITHOUT CHRONO = 57 MONTHS, WITH CHRONO 1H/D = 41 MONTHS
DURÉE DE VIE DE PILE: SANS CHRONO = 57 MOIS, AVEC CHRONO 1H/J = 41 MOIS
BATTERIELEBENSDAUER: OHNE CHRONO = 57 MONATEN, MIT CHRONO 1STD/T = 41 MONATEN